

317

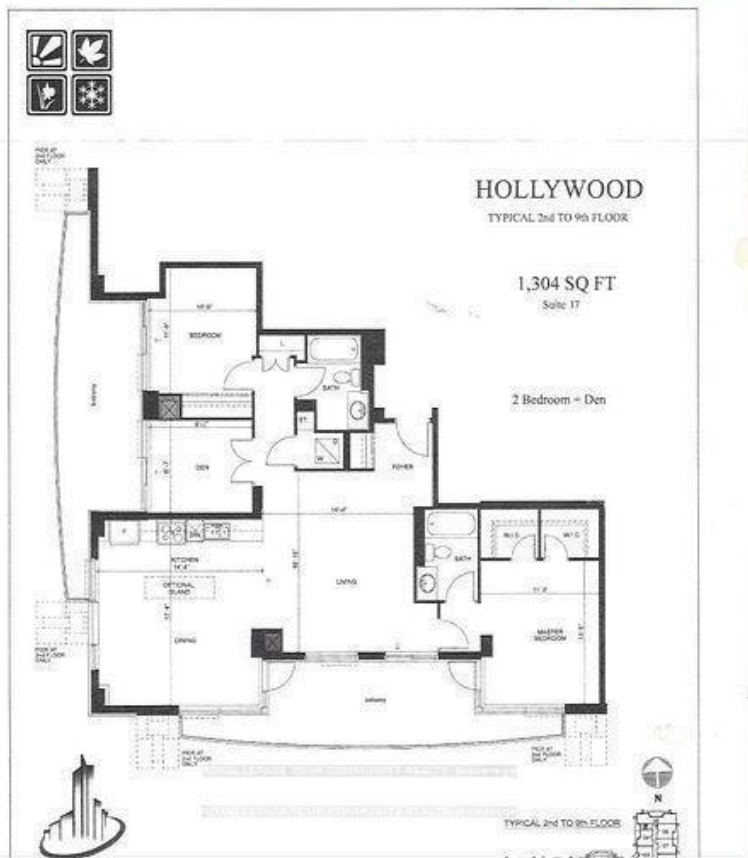

75 Norman Bethune Avenue 317 Richmond Hill Beaver Creek Business Park Ontario

\$789,900

Four season garden Luxury Condominium In Prime Richmond Hill East Beaver creek & Highway 7, Extra Large & Bright South West Corner Unit (1,304Sf) With 3 Bedrooms, 2 Washrooms and 2 Large Terraces, Each bedroom with access to the large balconies as well as the Kitchen, Lots Of Windows, 2 Doors Walkout To Terrace. The Largest Unit In The Building! Open concept living, Kitchen countertop. Short Walk To Shopping, Restaurants & Entertainment District, Close To Hwy 7, 404 & 407 & All Other Amenities. 2 Parking And 1 Locker included. The unit is being sold under Power of Sale (id:6769)

- Bedroom 3.41 m X 4.11 m
- Bedroom 2 3.59 m X 3.048 m
- Bedroom 3 2.65 m X 2.95 m
- Kitchen 5.3 m X 4.39 m
- Dining room 5.3 m X 4.39 m
- Living room 4.9 m X 4.39 m

Listing Presented By:



Originally Listed by:
ROYAL LEPAGE YOUR
COMMUNITY REALTY

<http://land-investmentgroup.ca/>



Royal

LePage

#4002 - 2271 Harvey Ave ,
Kelowna, BC,

Phone: (250) 860-1100
lorneayers@royallepage.ca