

**SUBDIVISION PLAN**  
(EPP111147, Block 72, Comox Land District)  
**THE RISE PHASE V**  
SCHEDULE "A"

1716 Crown I. Blvd.

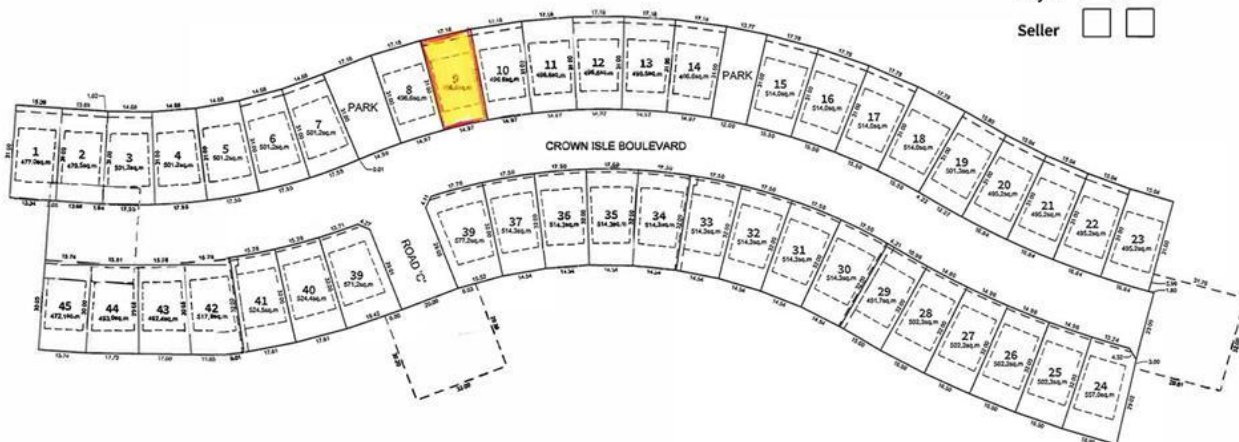

Date \_\_\_\_\_  
Buyer ☐ ☐  
Seller ☐ ☐



MLS#953471

# 1716 Crown Isle Blvd Courtenay BC

\$429,900

Welcome to The Rise in the prestigious Crown Isle community. Build your own custom dream home in this new and upcoming neighbourhood. Close to all amenities including hospital, schools, college, CFB Comox, airport and all levels of shopping.

Listing Presented By:



Originally Listed by:  
Royal LePage-Comox Valley (CV)

gregghart@royallepage.ca



Royal

**LePage in the Comox Valley**

121-750 Comox Road , Courtenay,  
BC, V9N3P6

Phone: 250-702-5950

Fax:

corony@shaw.ca