

# Parcel Map

Property Address: 11948 88 Street, EDMONTON T5B3S1

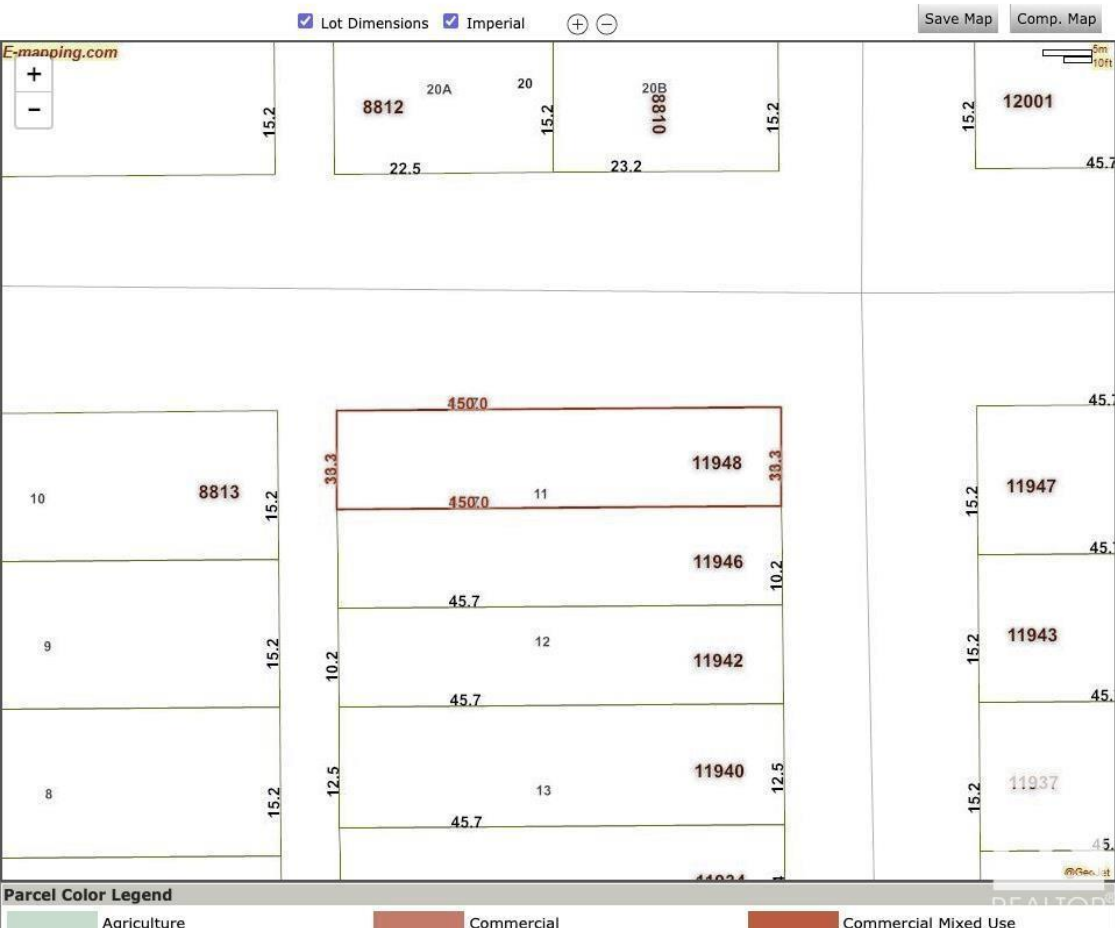

## Edmonton Alberta

\$350,000

Discover the potential of this spacious 33' x 150' corner lot located in the rapidly transforming central community of Eastwood. Surrounded by a wave of infill development, the area is home to new duplexes, skinny homes, fourplexes, and triplexes--making this an ideal investment for builders and developers. Directly across the street is a cash-flow positive 8-plex, highlighting the strong rental demand and income potential in the area. With the ability to build up to 6 units, this property may also qualify for the CMHC MLI Select program, offering added financial incentives for the right project. Seller is open to a JV with a builder. An older, boarded-up home currently sits on the lot. Whether you're looking to build and hold, or sell upon completion, this is an exceptional opportunity in a growing urban neighborhood. (id:6769)

Listing Presented By:



Originally Listed by:  
MaxWell Polaris

<https://www.bikrambathh.com/>

**RE/MAX ELITE**

**RE/MAX Elite**

Phone: 780-406-4000

Fax:

[executive@eliterealestate.ca](mailto:executive@eliterealestate.ca)