



Dugenta VII

Job 2562-WB

221 Larch Crescent, Leduc

1,622 sqft
 9'-1" Main Floor Ceiling Height
 Vinyl Plank throughout Main Floor
 Side Entrance
 Appliance Allowance
 Quartz Countertops in Kitchen & Bathrooms
 Tile in all Second Floor Bathrooms
 Stand-up Shower in Ensuite
 High Efficiency Furnace

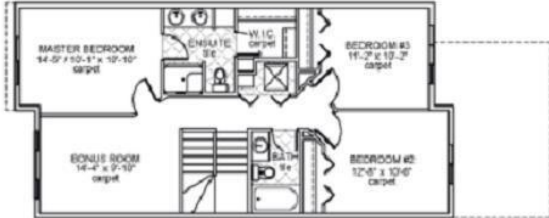

Upper Floor Area: 891 sqft

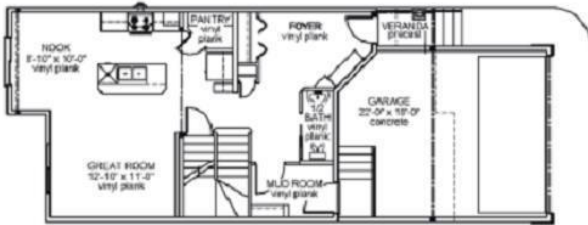

Main Floor Area: 731 sqft

Leduc Alberta

\$514,900

Built by Award Winning Montorio Homes in the desirable community of Woodbend, Leduc. This Single Family Home offers 3 Bedrooms, Bonus Room and 2.5 Bathrooms with the Convenience of Upstairs laundry. A Bright and Beautiful Kitchen with Extended Island. Quartz Countertops, Tile Backsplash, Soft Close Cabinets throughout, 9' Ceiling, Luxury Vinyl Planking. Plenty of large windows providing an abundance of natural light, south backing yard and A SEPERATE ENTRANCE to the Basement for future rental income generating suite and Double Attached Garage. Woodbend is where the sky and green go on for miles, where the air feels light, and where we call home. A place where life slows down, Woodbend will make you stop, breathe in, and enjoy the scenery. Close to all amenities and easy access to the Airport and City of Edmonton Limits. House is estimated to be ready for June 2025. Note: House is still under construction and pictures are of a similar home, colors/finishing may differ to actual property. (id:6769)

Living room Measurements not available

Dining room Measurements not available

Kitchen Measurements not available

Primary Bedroom Measurements not available

Bedroom 2 Measurements not available

Bedroom 3 Measurements not available

Bonus Room Measurements not available

Listing Presented By:



Originally Listed by:
 Century 21 Leading

RE/MAX ELITE

RE/MAX Elite

Phone: 780-406-4000

Fax:

executive@eliterealestate.ca