

3808 35 Avenue 101 Vernon British Columbia

Alexis Park

\$435,000

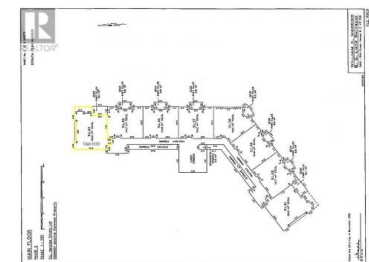

Desirable Turtle Mountain Estates. Prime 2 bedroom 2 bath corner unit in the north east corner of building # 2. Largest floorplan available and a very roomy and spacious 1246 sq ft home with 2 bedroom, 2 baths and an in-unit mechanical / storage room. Great flow and floorplan with lots of windows and natural light. East exposure with a sweeping views from Silver Star, the BX, the City and valley. Large east facing covered deck with the morning sun and afternoon shade. Very functional floorplan with open kitchen and dining. Gas fireplace, oak kitchen, laminate flooring. Not many recent upgrades but clean, nicely maintained and close to "move in ready" Private storage room just down the hall, dedicated underground parking, spacious and functional lobby, common social room, and lots more. No age restricted building but predominantly adult 55 +. Conveniently located close to downtown Vernon and transit. Vacant and easy to view and quick possession available. Call for more information or to book an private appointment to view. (id:6769)

Don Defeo

RE/MAX Vernon

Phone: (250) 558-8762

<http://www.vernonrealestate.com/>



RE/MAX Kelowna
 100-1553 Harvey Avenue
 Kelowna, BC,
 Canada