

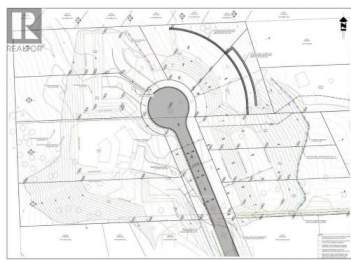

1170 CRESTWOOD Drive Kamloops British Columbia

Barnhartvale

\$373,000



Introducing 1170 Crestwood Drive, a 15,087 square foot estate-style property with spectacular views. The lot is fully serviced and build-ready, located within a brand new cul-de-sac in Barnhartvale. This lot is zoned R7 which allows for residential suites and you can also build up to 35% of the lot size, allowing you to build your dream home. The orientation of the lot provides incredible views of the South Thompson Valley and is located 15 minutes to downtown Kamloops. This property is located close to an elementary school, recreation (hiking, biking), many amenities (Dallas Town Centre, The Pond Country Market) and close to public transportation. This opportunity is a rare offering as Barnhartvale is limited to new subdivisions. Ready to build your ultimate home! Contact us today for a full listing package. GST and DCC not included in purchase price. (id:6769)

Terry Lynds

eXp Realty (Kamloops)

Phone: (250) 682-5986

<http://mykamloopslistings.com/>



RE/MAX Kelowna
100-1553 Harvey Avenue
Kelowna, BC,
Canada