

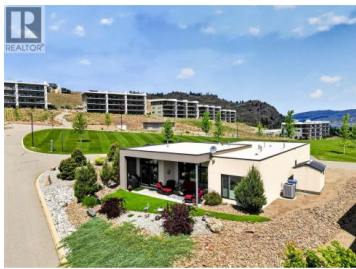

**121 Ridge Park Penticton British Columbia**  
 Husula/West Bench/Sage Mesa  
**\$999,000**



CLICK TO VIEW VIDEO: Wake up to Skaha Lake shimmering beyond your windows. At 121 Ridge Park in Penticton's coveted Skaha Hills, this rare detached rancher offers the freedom of single-level living with views that simply stop you in your tracks. One of the few standalone 1 level homes in this resort-inspired community. This 2-bed, 2-bath retreat built in 2017 delivers the spaciousness and privacy you've been looking for. Soaring 10-foot ceilings and an open-concept layout fill every room with light, while the chef-friendly kitchen with pantry makes entertaining effortless. Retreat to a generous primary suite with a walk-in closet and ensuite, then step outside to your private patio to breathe in the lake air and see the Okanagan unfold before you and the life you imagined finally feels real. A double garage, hot water on demand, and nearby guest parking handle the practical side leaving you free to enjoy everything Skaha Hills was built for: a pool, hot tub, tennis, pickleball, a clubhouse, and trails that connect directly to the legendary Kettle Valley network. More is coming. Indoor pickleball, golf simulators, and expanded parks are on the way. No stairs. No condo compromises. Just easy, low-maintenance Okanagan living at its absolute finest. (id:6769)

**Brenden Flundra**

eXp Realty

Phone: (236) 239-1237

<http://www.neuhouzz.ca/>



**RE/MAX Kelowna**  
 100-1553 Harvey Avenue  
 Kelowna, BC,  
 Canada

