

133 TIMBERSTONE Place Penticton British Columbia

Wiltse/Valleyview

\$327,000



Welcome to Timberstone Ridge. This quiet executive community is situated on a no through street ending in a cul de sac. Located a stone's throw away from Wiltse Elementary school, near to recreation, shopping, secondary schools and more. This lot features impressive surrounding westerly views of Penticton's beautiful Okanagan Lake, gorgeous mountains and the city in the valley below. This can be the right fit for your dream home. (id:6769)



Brad Schedel

2 Percent Realty Interior Inc.

Phone: (250) 488-2102

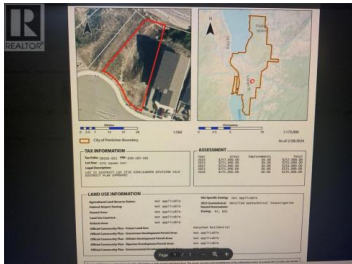
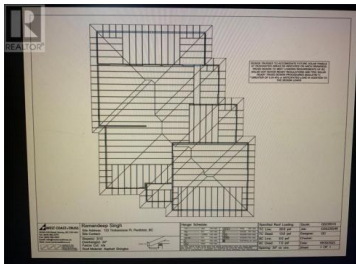
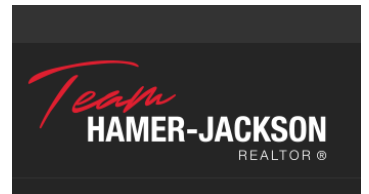

RE/MAX Kelowna
100-1553 Harvey Avenue
Kelowna, BC,
Canada