



415 Commonwealth Road 299 Kelowna British Columbia

Lake Country East / Oyama

\$143,900



Privacy plus on this large 3541 sq ft corner lot. The ideal lot for your future park model home complete with an Okanagan Room for extra living space. It is conveniently located across the street from the Family Activity Centre where you will find the restaurant, coin laundry, outdoor pool, hot tub, playground and shuffleboard. Other amenities in Holiday Park Resort include golf course, pools, hot tubs, games room, gym, golf course, pickleball court, fenced in off-leash dog park. Lease term to 2046. Leasehold interest is registered with the Federal Government. Long and short term rentals allowed. Parking for 2 vehicles plus a golf cart. Close proximity to Kelowna International Airport, wineries, golf courses, shopping and entertainment. (id:6769)

Marion Lahey

Coldwell Banker Horizon Realty

Phone: (250) 860-7500

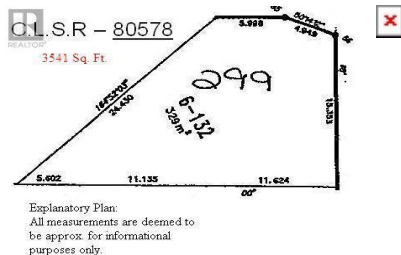
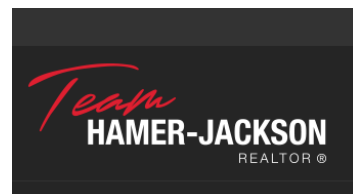

RE/MAX Kelowna
100-1553 Harvey Avenue
Kelowna, BC,
Canada