



## 31 Jules Gravel Crescent Armstrong Earlton Ontario

Earlton

# \$34,900



Rare opportunity to own a spacious, level lot in a nearly fully built-out subdivision. Essential services, including municipal water, sewer, hydro, and garbage collection, are readily available at the lot line, making it easy to start planning. Tucked away on a quiet, low-traffic street, this corner property sits in a peaceful, established setting. A great location to bring your vision to life and build the home you've always wanted. (id:6769)

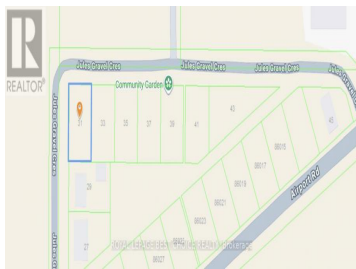

**Alexandra De Bernardi**

ROYAL LEPAGE BEST CHOICE REALTY

Phone: (705) 961-0039

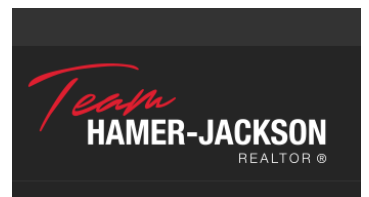

**RE/MAX Kelowna**  
100-1553 Harvey Avenue  
Kelowna, BC,  
Canada