

Regina Saskatchewan
 Harbour Landing
\$129,900

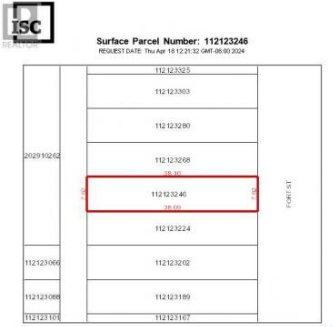

TEN 25' x 125' undeveloped residential lots in Devonia Park or Phase IV of West Harbour Landing. Devonia Park is a quarter section of land originally subdivided into 1,400 lots in 1912. Investment opportunity only at this time with potential to build on in the future. Brokerage sign at the corner of Campbell Street and Parliament Avenue. GST may apply to the sale price. More information in the 'West Harbour Landing Neighborhood Planning Report'. There will be other costs once the land is developed. (id:6769)

Shirley A MacFarlane
 Global Direct Realty Inc.
 Phone: (306) 536-9127
<http://www.shirleymacfarlane.com/>

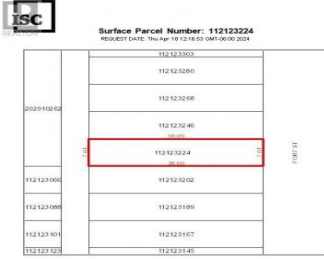
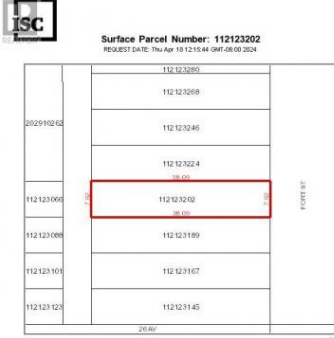
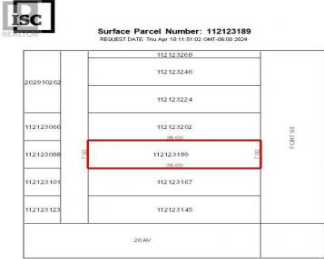
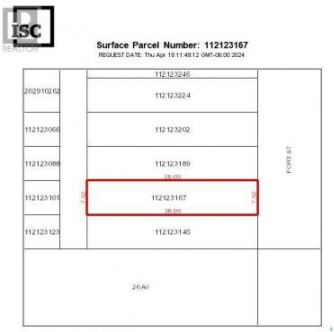
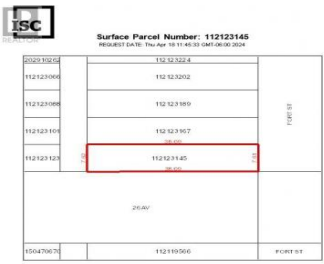
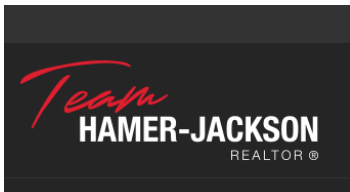



RE/MAX Kelowna
100-1553 Harvey Avenue
Kelowna, BC,
Canada