

4005 PESKETT Place Naramata British Columbia

Naramata Village

\$1,595,000

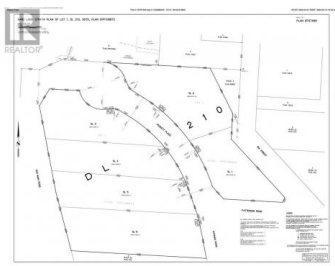

Travel down the enchanting Naramata Bench, bathed in golden sunlight, its vistas cradled by sprawling vineyards, and discover Peskett Place—a sanctuary where dreams are sculpted into reality. Here, you have the privilege to select the perfect parcel to create your dream residence, a place of no compromise, surrounded by the awe-inspiring beauty of Lake Okanagan. Naramata transcends its reputation as a premier winery destination; it is a poetic whisper amongst the vines, a place of enchantment. This exclusive 5-lot enclave is nestled in the heart of wine country, offering both tranquility and splendor. Trails beckon for exploration, bike paths await the turn of wheels, orchards heavy with fruit offer their bounty, and vineyards weave a green mosaic across the landscape. The addition of trail access to Manitou Park and the lakefront enriches this already captivating locale. With over 40 wineries within reach, your palate can dance to the flavours of Merlot, Pinot Noir, Pinot Gris, and Chardonnay. Adventure seekers will find delight in the nearby Kettle Valley Trail, while those in search of serenity can indulge in the quiet beauty of the lake's shores, while the conveniences of Penticton are just moments away. At Peskett Place, the canvas is pristine, awaiting your vision and creativity. These generous lots offer a rare opportunity to claim a slice of paradise. Embrace the r...



RE/MAX Kelowna
100-1553 Harvey Avenue
Kelowna, BC,
Canada

Scott Jenvey

Sotheby's International Realty Canada

Phone: (250) 808-6240

<https://scottjenvey.com/>

