

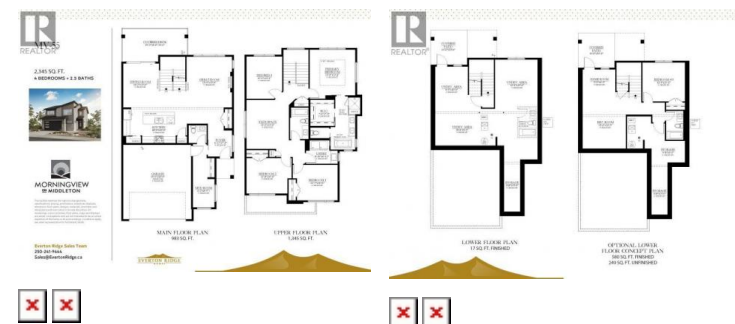

## 465 Morningview Drive Coldstream British Columbia

Mun of Coldstream

# \$1,314,955



Discover the space, comfort, and flexibility of this Everton Ridge Built Home - a thoughtfully designed 2,345 sq.ft. residence that adapts to your lifestyle. Whether you're looking for room to grow or a place to entertain, MV55 offers the perfect balance of function and Okanagan-inspired living. Highlights include: Up to 5 bedrooms - including an upper den that can easily be converted to a bedroom Spacious, sunlit mudroom - ideal for active families. Expansive rear deck - enjoy incredible views and seamless indoor-outdoor living. Elegant 4-piece spa-inspired ensuite - featuring a freestanding tub for relaxing soaks. Convenient upper-floor laundry - with sink and added storage space. Versatile flex space - perfect for a media room, play area, or quiet study zone. MV55 is built for how you live today, with the flexibility to grow into tomorrow. Discover how this home can work for you and book an appointment with our sales team today. (id:6769)



**RE/MAX Kelowna**  
100-1553 Harvey Avenue  
Kelowna, BC,  
Canada

### Peter Berzins

Summerland Realty Ltd.

Phone: (250) 212-9212

<https://openhousebc.com/>

