

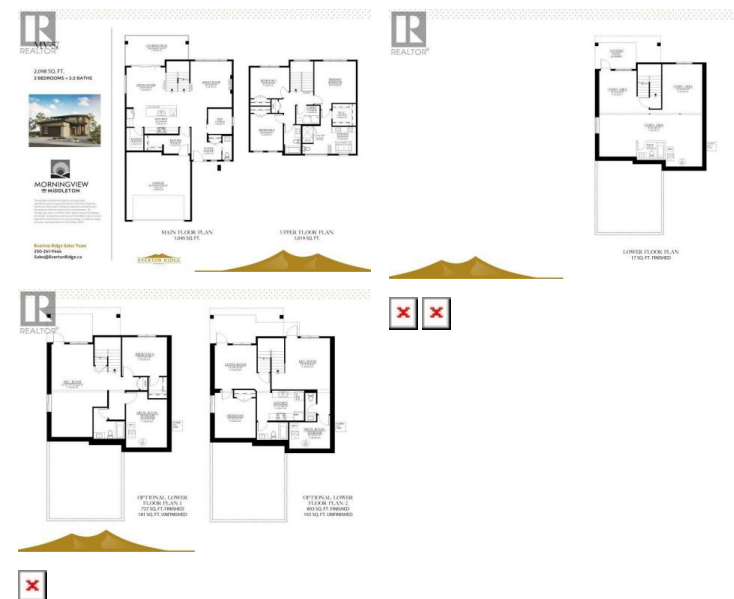

473 Morningview Drive Coldstream British Columbia

Mun of Coldstream

\$1,269,995



Welcome to Morningview at Middleton. This 2,081 sq.ft. Everton Ridge Built home delivers flexibility, comfort, and elevated everyday living. With thoughtful design elements and optional layouts, this home is built to suit a variety of lifestyles. Key features include: Spacious walk-in pantry - ideal for organized, functional kitchen storage. Main floor den - perfect for a home office or quiet retreat. Expansive rear deck - enjoy relaxing or entertaining with wonderful views. Upper-floor laundry - conveniently located near the bedrooms. Spa-inspired ensuite - includes a freestanding tub and tiled shower with bench. Generous-sized bedrooms - designed for comfort and space. Flexible layout - choose a 1-bedroom legal suite or convert to a 4th bedroom with rec room for added living space. With 3 bedrooms, 2.5 baths, and a double garage, MV57 offers family-functional, stylish living with room to grow. Explore the options and make it your own. (id:6769)



RE/MAX Kelowna
100-1553 Harvey Avenue
Kelowna, BC,
Canada

Peter Berzins

Summerland Realty Ltd.

Phone: (250) 212-9212

<https://openhousebc.com/>

