

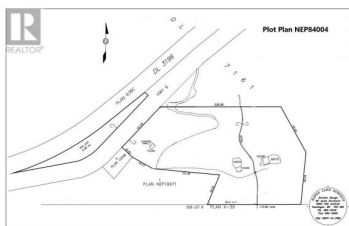

4820 6 Highway Winlaw British Columbia

Passmore/Winlaw/Slocan

\$795,000



Nestled in a mature forest setting, this property boasts two charming homes and a rental cabin on a scenic 11.94-acre lot. The "Mountain Home" features 3 bedrooms, 1.5 baths, and a crystalline stone-mason chimney, while the "Cedar Home" boasts 3 bedrooms, 1 bath, and a full footprint walkout basement. Enjoy the peaceful sound of Bodini Creek as you relax porch-side, nourished by a constant supply of pristine spring water. With no zoning restrictions, this property offers opportunities for extended family homes, bed & breakfast lodging, or shop. The lot has great potential for further development with a flat building area on a lower bench which requires some clearing, which will net you some building material. Conveniently located just 35 minutes from both Nelson and Castlegar. Contact your REALTOR for interior photos and respect tenant's privacy. (id:6769)



Bill Lander

Coldwell Banker Rosling Real Estate (Nelson)

Phone: (250) 551-5652

<http://www.billlander.ca/>



RE/MAX Kelowna
100-1553 Harvey Avenue
Kelowna, BC,
Canada