

## 3398 Davison Road 7 Vernon British Columbia

Bella Vista

**\$449,900**

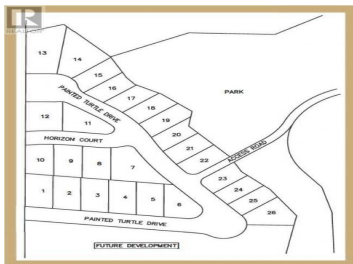

Turtle Mountain provides incredible Okanagan Lake and valley views. Live within the amazing nature Vernon has to offer while being only steps away from local amenities and the city's core. Enjoy also the Grey Canal hiking trail and mesmerizing Bella Vista views, world famous beaches, award winning wineries and spectacular golf courses. They are only minutes away! Tassie Creek Estate has been created to help celebrate all that this region has to offer. A stunning 5 acre park with all its beauty compliments the estate's area and outdoor living. Build your dream home the way you want with the builder you desire. Choose a customized layout, and take 20 months to build. The possibilities of this property are endless. (id:6769)

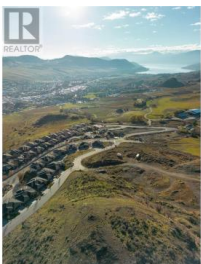
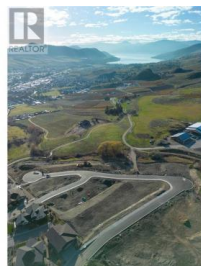

### Amber Lee

Century 21 Executives Realty Ltd

Phone: (250) 306-2706

<http://www.amber-lee.ca/>



RE/MAX Kelowna  
100-1553 Harvey Avenue  
Kelowna, BC,  
Canada