

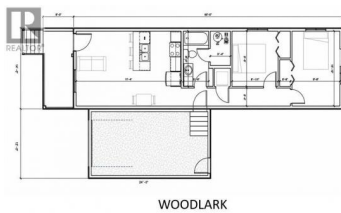

8900 Jim Bailey Road 84 Kelowna British Columbia

Lake Country East / Oyama

\$335,000



WOODLARK



Step into the Woodlark floor plan in Deer Meadows Estates, a welcoming, family- and pet-friendly community designed for easy Okanagan living and outdoor enjoyment. No need to wait on construction--this 2024-built home is move-in ready and comes with no GST. Featuring 2 bedrooms, 1 bathroom, and a thoughtfully designed open-concept layout by Woodland Crafted Homes, it offers both comfort and functionality. The bright front patio leads into the kitchen, living, and dining areas, while the primary bedroom is quietly set at the rear with direct access to a private patio and fully fenced, level backyard. Outside, you'll find a large deck and storage shed, with plenty of room to create your ideal outdoor space--whether that's a garden, green space, or custom retreat. Inside, the home is complete with stainless steel appliances, in-suite laundry, window coverings, and modern finishes throughout. Just steps away, the Rail Trail connects you to the stunning waters of Kalamalka and Wood Lake, with pathways running from Vernon to Kelowna. With flexible rental options, including short-term, and pet-friendly policies, this property is a great fit for first-time buyers, investors, families, or those looking to downsize. Conveniently located only 10 minutes from YLW and UBCO, and close to golf, shopping, and everyday amenities, Deer Meadows Estates offers the perfect blend of lifestyle and...



RE/MAX Kelowna
 100-1553 Harvey Avenue
 Kelowna, BC,
 Canada

Donna Fuller

One Percent Realty Ltd.

Phone: (604) 683-1393

