

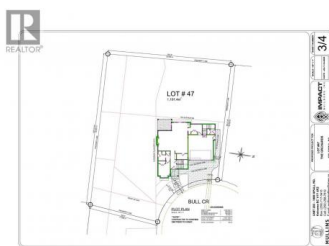

900 Bull Crescent Kelowna British Columbia

Lower Mission

\$529,900



Welcome to one of the most desirable locations in Kelowna's sought-after Lower Mission - The Orchards. This prime building .29-acre residential lot is ideally situated on a quiet semi-cul-de-sac, offering the perfect blend of privacy and convenience. Backing onto ALR land and mature treed space, the setting provides exceptional tranquility and a beautiful natural backdrop. Design and build your dream home with confidence, knowing you're among a community of high-end, preferred builders including Thomson Dwellings, Align West Homes, Impact Builders, Carrington Homes, Gibson Custom Homes, and Kimberley Homes. Enjoy the ultimate Okanagan lifestyle with beaches, top-rated schools, award-winning wineries, parks, recreation, shops, and restaurants just minutes away. Whether you're building for family living or luxury retreat, this is an unbeatable opportunity to create something special in one of Kelowna's premier neighborhoods. Your future home starts here - secure your piece of Lower Mission today! (id:6769)

Paul Neufeld

RE/MAX Kelowna

Phone: (250) 470-1044

<http://www.neufeldhomes.com/>

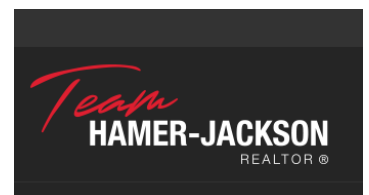

RE/MAX Kelowna
100-1553 Harvey Avenue
Kelowna, BC,
Canada