

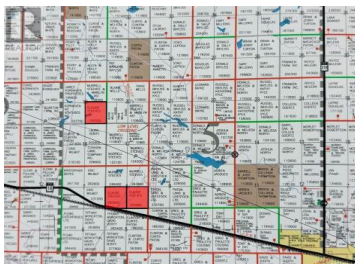

Mount Pleasant Rm No. 2 Saskatchewan

\$1,880,000

SASK MLS®



Big opportunity to own 3 great quarters in the RM of Mount Pleasant No.2, West of Carnduff SK. 477.65 total acres (ISC), with SAMA showing 432 cultivated acres. Total assessment of \$716,400 with an average of \$238,800 per quarter. Soil association is Oxbow Loam with a soil final rating/weighted average of 61.43. List price is 2.62x assessment or \$3,936 per ISC acre & \$4,350 per SAMA cultivated acres. Soil Class G/J as per SCIC. Surface leases totaling \$13,464/year are included. Majority of surface leases are recent, including the battery site. S1/2 8-3-33 is currently rented for 2025 and available to farm in 2026. Please call for more information. (id:6769)

Brad Wilson

Mack Realty

Phone: (306) 461-6705

<http://mackrealty.ca/>



RE/MAX Kelowna
100-1553 Harvey Avenue
Kelowna, BC,
Canada