

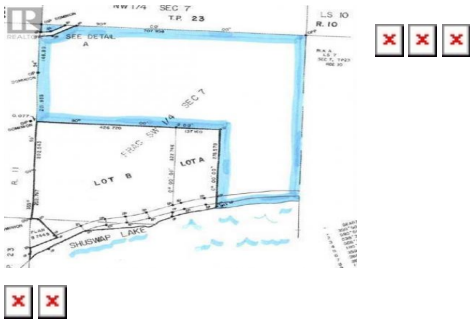

**Part SW 1/4 Squilax-Anglemont Road Celista British Columbia**  
 North Shuswap  
**\$1,100,000**



Potential, Potential, Potential. Own your own 96 acres of prime Shuswap Property. Build your dream getaway or look at the potential for subdivision or development. Minutes away from the beautiful community of Scotch Creek this property has it all, lake access, lakeview, mountain view, etc. Motivated seller. Priced at tax assessment. Lot has been affected by the BC wildfires. (id:6769)



**RE/MAX Kelowna**  
 100-1553 Harvey Avenue  
 Kelowna, BC,  
 Canada

**Lavern Bazin**  
 Century 21 Lakeside Realty Ltd.  
<http://lavernonthelake.com/>

