

UNIT 606

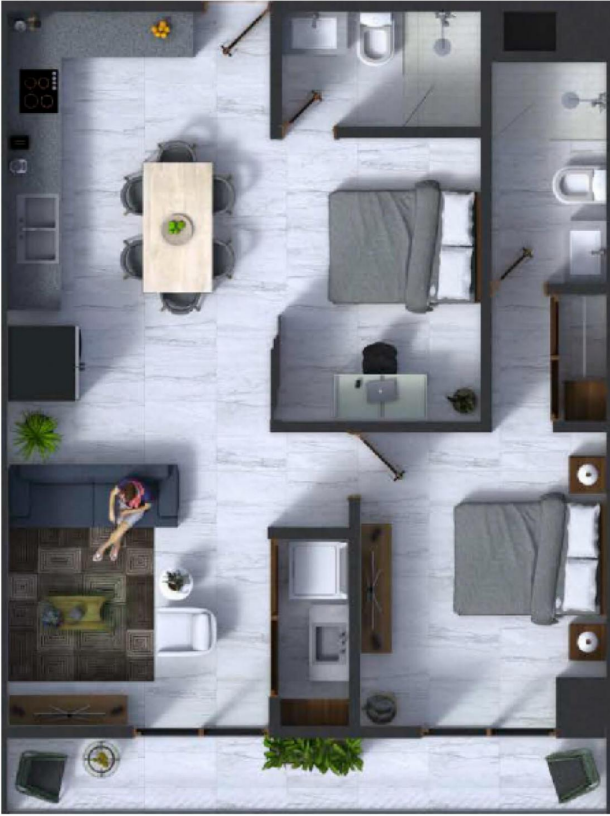

All artist renderings, sketches, graphic materials, plans, specifications, features, dimensions, amenities, existing or future views, and photos depicted or otherwise described herein are proposed and conceptual only. They are based upon preliminary development plans, which are subject to withdrawal, revisions, and other changes without notice.

333 Francisca Rodriguez 606 Puerto Vallarta

\$519,054

Ubicado en EL CORAZON DE LA ZONA ROMANTICA de PUERTO VALLARTA en la salida de la autopista Vallarta-Mismaloya. Entre los servicios disponibles en la ubicacion de ROMANTIKA estan dos Hospitales, una diversa gama de restaurantes, a 3 cuadras de la zona de bares y a 5 cuadras de la playa de Los Muertos para disfrutar de dias soleados y atardeceres increíbles durante todo el año. Located in THE HEART OF PUERTO VALLARTA'S ROMANTIC ZONE at the Vallarta-Mismaloya highway exit. Among the services available in the ROMANTIKA location are two Hospitals, a diverse range of restaurants, 3 blocks from the bar area and 5 blocks from Los Muertos beach to enjoy sunny days and amazing sunsets all year round.

Listing Presented By:



Originally Listed by:
CONDOMEX Real Estate Group



Pacifico Property

Calle Miramar 25 C Sayulita,
Nayarit. 63734, Sayulita, Nayarit,
V1V2R1

Phone: +1 888 228 2710
Fax:
hola@pacificoproperty.com