

## UNIT 802

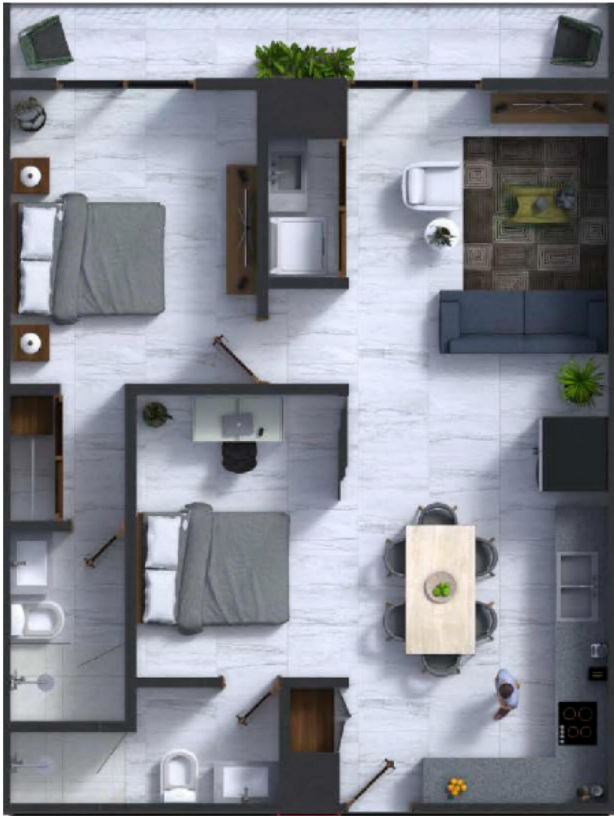

All artist renderings, sketches, graphic materials, plans, specifications, features, dimensions, amenities, existing or future views, and photos depicted or otherwise described herein are proposed and conceptual only. They are based upon preliminary development plans, which are subject to withdrawal, revisions, and other changes without notice.

## 333 Francisca Rodriguez 802 Puerto Vallarta

\$565,981

Located in one of the most iconic areas of PUERTO VALLARTA; THE HEART OF THE ROMANTIC ZONE, specifically at the Vallarta-Mismaloya highway exit. ROMANTIKA'S location leads to every service available in the area within steps. Two Hospitals, a vibrant and diverse range for restaurants, 3 blocks from the bar area and 5 blocks from Los Muertos beach to enjoy sunny days and amazing sunsets throughout the year.

Listing Presented By:



Originally Listed by:  
CONDOMEX Real Estate Group



**Pacifico Property**

Calle Miramar 25 C Sayulita,  
Nayarit. 63734, Sayulita, Nayarit,  
V1V2R1

Phone: +1 888 228 2710  
Fax:  
hola@pacificoproperty.com