

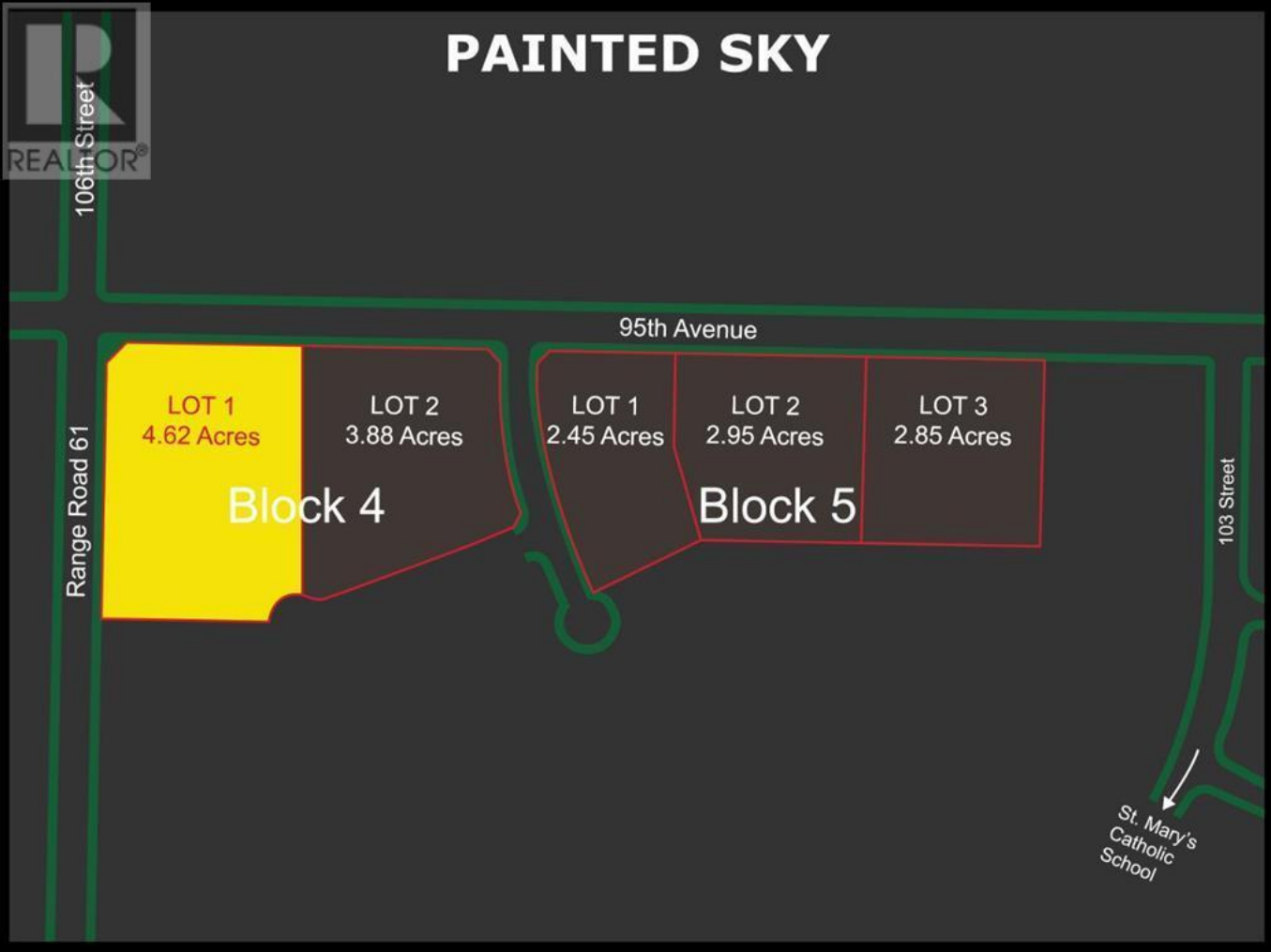

PAINTED SKY



0 95 Avenue Sexsmith Alberta

\$438,900

Anchor your business into the community of Sexsmith. Are you ready to make a can't-miss-it debut in the Town of Sexsmith - or to showcase the success your hard work and reputation has brought you already by building to stay? Grading is completed and water (since 2005) and sewer (since 2018) is already there. Phase 3 power is across the road on 95 Ave. Many people who call Sexsmith home (and more people besides) travel this main artery through Sexsmith each day - so there isn't a better place to Anchor in. In addition to a main road exposure, these commercially planned lots front the recent "Painted Sky" subdivision where attractive Phase 1 houses and a K-8 school are traveled to each day and foreshadow where the newest Sexsmith residents will buy-into the small-town charm Sexsmith offers. The proposed plan for Painted Sky also in pictures. It IS the place to be. Act soon and choose from your choice of commercial lots available. This is one of them. (id:6769)

Listing Presented By:



Originally Listed by:
RE/MAX Grande Prairie



Royal

Lepage Parkside Realty

PO Box 930; 9925 Main St,
Summerland, BC,

Phone: (250) 462-4888
info@joepeters.ca