

LAND USE DESIGNATIONS

Each parcel in the City is assigned a land use designation as shown in Map 3. The following table provides direction for the type of development allowed in each designation.

TRANSIT-ORIENTED CORE

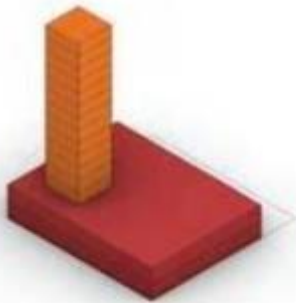

PURPOSE	Create a vibrant transit-oriented area with high densities and a mix of uses in close proximity to future SkyTrain stations, and existing high-frequency transit
BUILDING TYPE & HEIGHT	Multi-storey buildings up to 15 storeys. (Taller buildings may be achieved on properties not located within the Airport Zoning Regulation (AZR) as mandated by the Aeronautics Act and Transport Canada. Lower maximum building heights may be required for properties within the Langley Regional Airport (YNJ) Outer and Approach Surfaces, according to the AZR)
USES	<ul style="list-style-type: none"> • Mixed Use: Residential & Commercial • Multi-Unit Residential • Commercial
DENSITY	3.0 - 5.5 FAR* *Density bonusing policy applies as identified in the Zoning Bylaw.

5419 203 Langley British Columbia

\$2,700,000

This is a land Assembly. Area allows Multi-Storied Buildings up to 15 floors. Check with the city for complete possibilities and regulations. (id:6769)

Listing Presented By:



Originally Listed by:
RE/MAX 2000 Realty



Royal

Lepage Parkside Realty

PO Box 930; 9925 Main St,
Summerland, BC,

Phone: (250) 462-4888
info@joepeters.ca

The property information on this website is derived from the Canadian Real Estate Association's Data Distribution Facility (DDF®). DDF® references real estate listings held by various brokerage firms and franchisees. The accuracy of information is not guaranteed and should be independently verified. The trademarks REALTOR®, REALTORS® and the REALTOR® logo are controlled by The Canadian Real Estate Association (CREA) and identify real estate professionals who are members of CREA. The trademarks MLS®, Multiple Listing Service® and the associated logos are owned by CREA and identify the quality of services provided by real estate professionals who are members of CREA.